

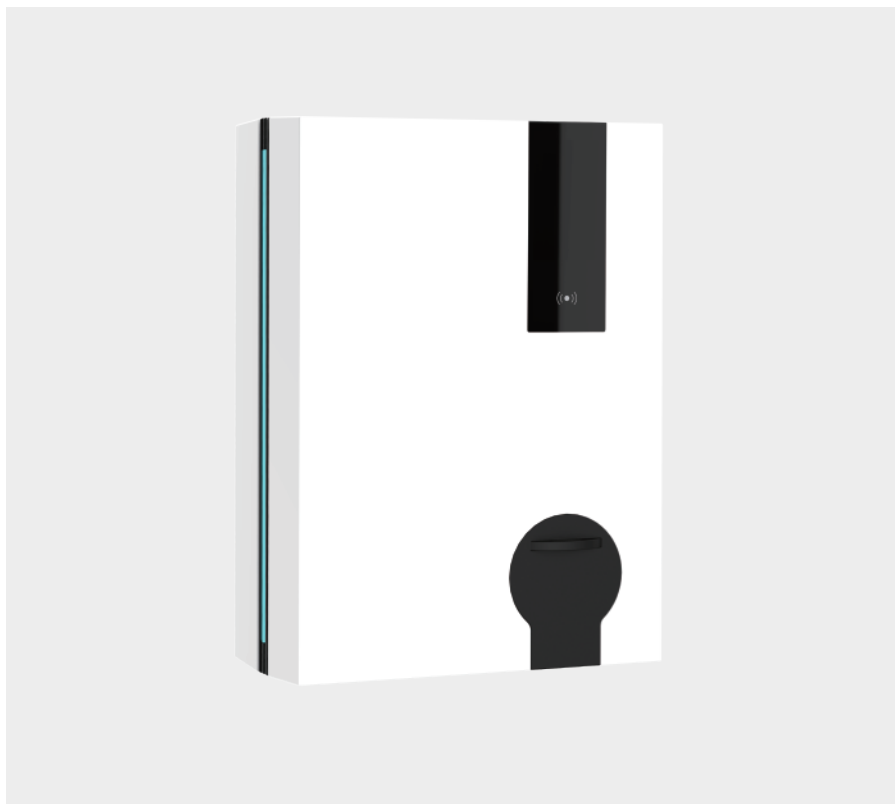

RAE DIAN

Quick Guide

NEO



What's in the box



X 1



X 2



X 1



X 4



X 4



X 2



X 2

Tools suggestion

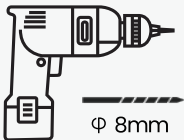

Φ 8mm

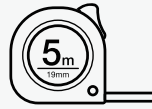

Hexwrench 5mm



Hexwrench 4mm

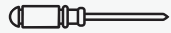
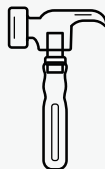

Phillips Screwdriver

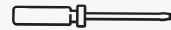

Slotted Screwdriver



Disclaimer

The information in this document is subject to change without notice and should not be construed as a commitment by RAEDIAN. RAEDIAN assumes no responsibility for any errors that may appear in this document.

1

Preparing

1.1 Power Cable Planning

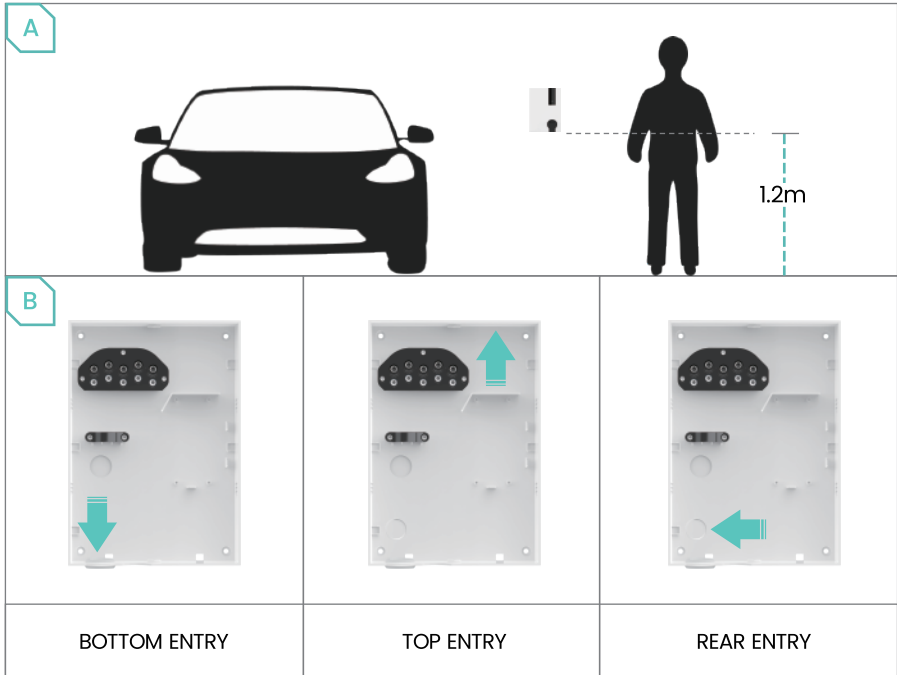

1.2 Ethernet Cable Planning



1.3 Ethernet Cable Entry

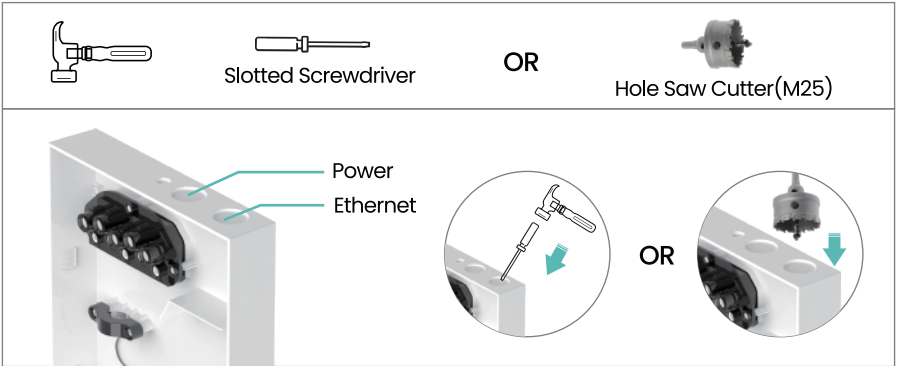

2 Mounting

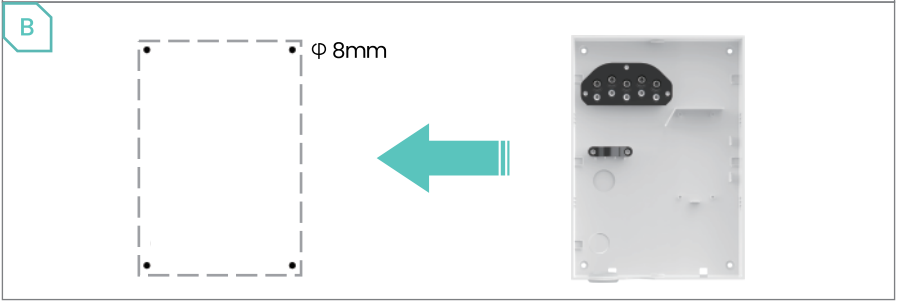
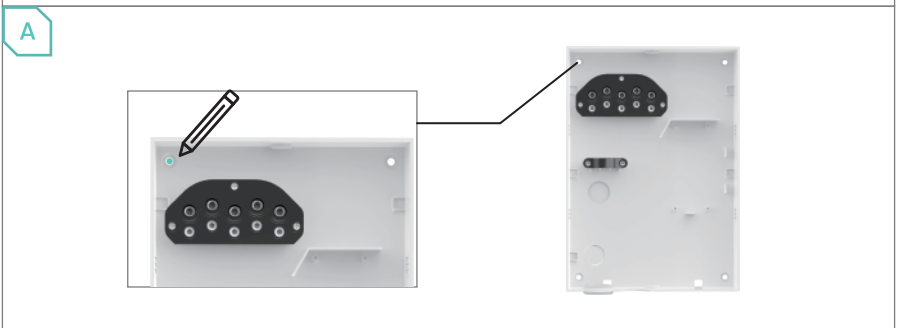
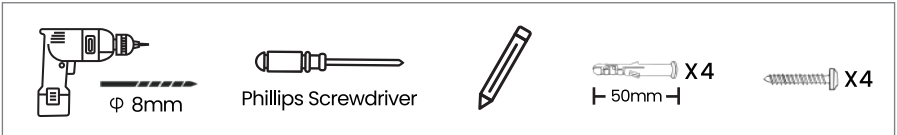

3

Wiring



Hexwrench 5mm



X 1

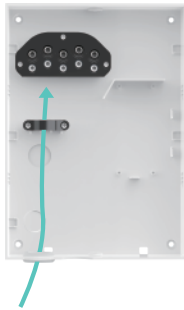

BOTTOM ENTRY

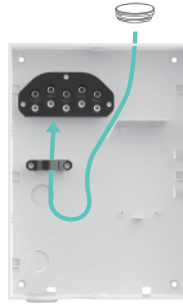

TOP ENTRY

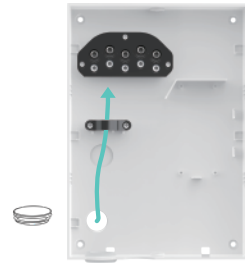

REAR ENTRY

1 Phase Connection

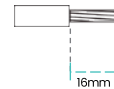
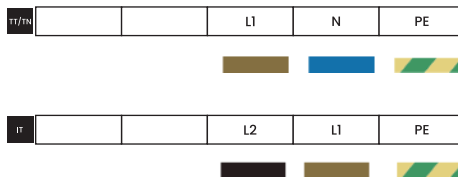

3 Phases Connection

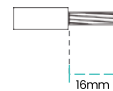
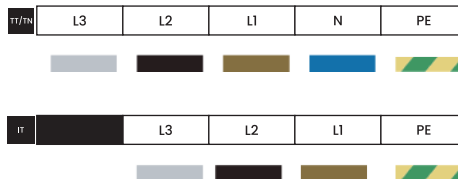

An external at least Type A RCD is required to be installed in the upstream.
Ensure the installation comply with all applicable laws and regulations.

4

Installing



X1



X1



Hexwrench 4mm



X2



X1

4.1 Connect Ethernet Cable (for Home Balance and Solar Charging)

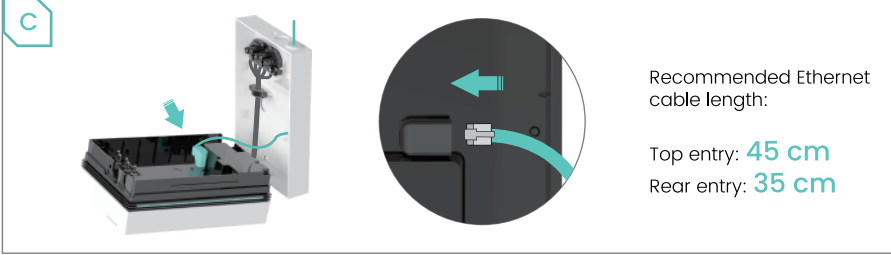
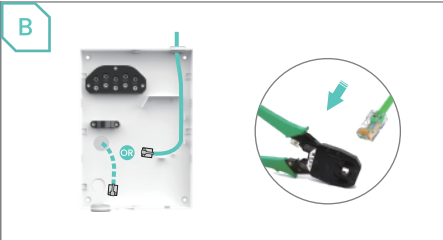
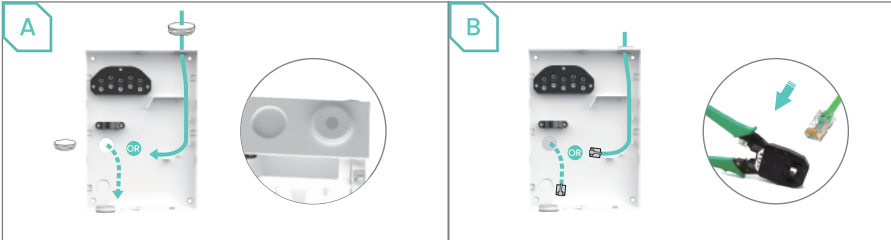

4.2 Complete Installation

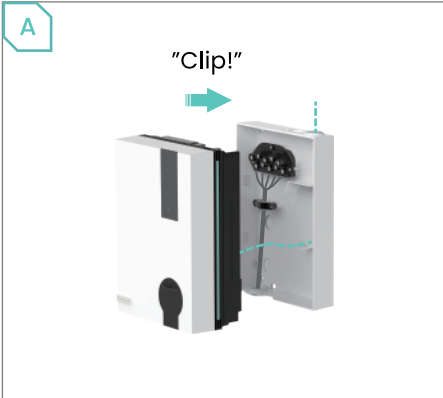

5.1 CT Clamp Positioning

5.1.1 Home Balance

Single phase

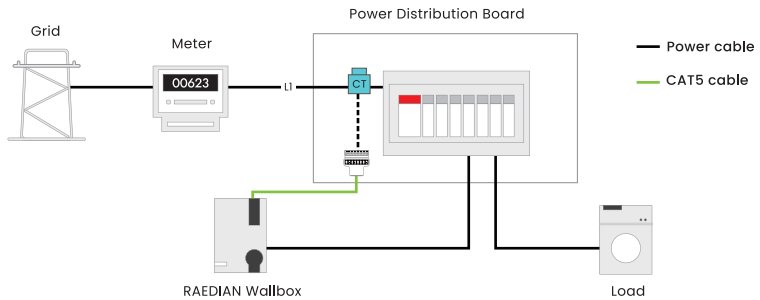

Three phase

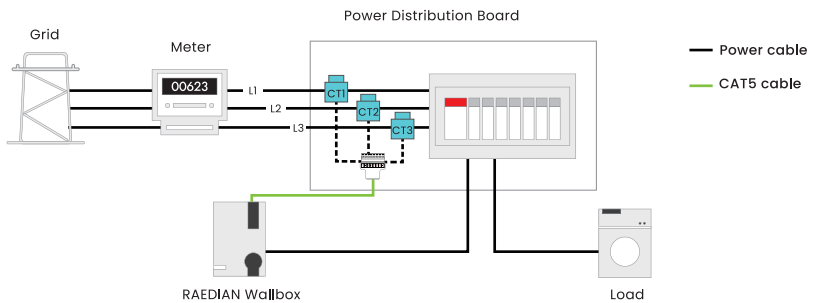

5.1.2 Solar Charging

Single phase home with single phase PV

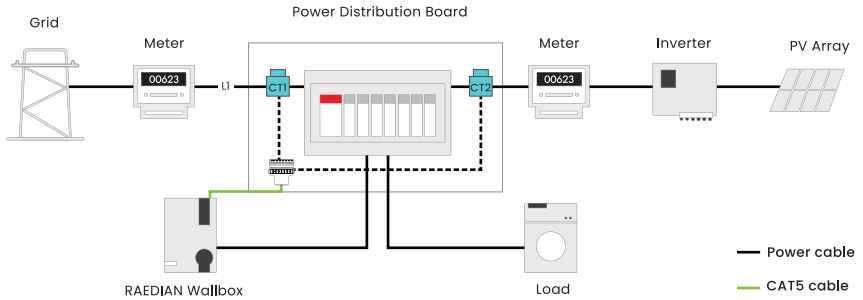

Three phase home with single phase PV

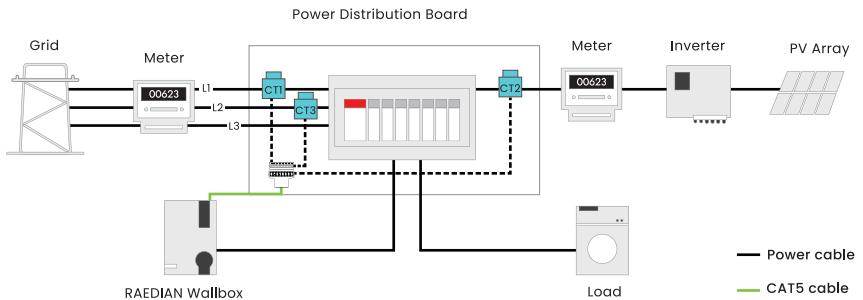

Three phase home with three phase PV

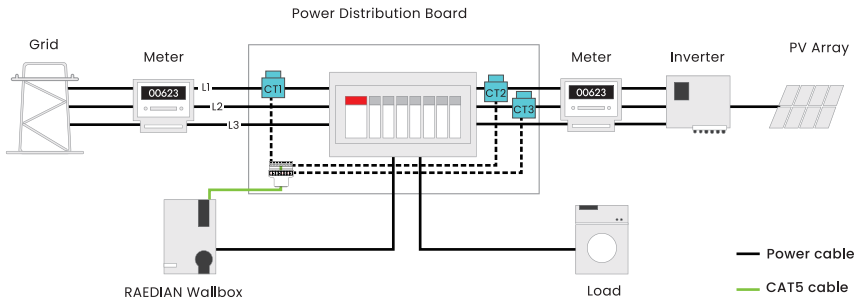

5.2 Install CT clamp

A Wire CT clamp to adaptor

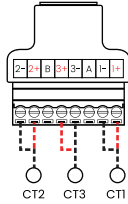

wiring sequence for straight through cable

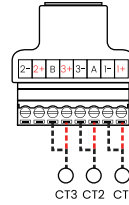

wiring sequence for crossover cable

B Close CT clamp

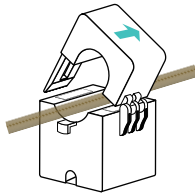

C Connect adaptor

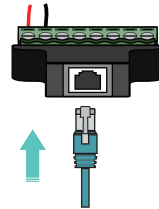





6

Get Started

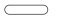
6.1 LED Indicators



LED Status	Definition
 White	Available
 Green	Cable plugged in: <ul style="list-style-type: none"> • Pending for authorization • Waiting for EV • Charging stopped by EV
 Cyan	Charging in progress
 Red	Fault state

6.2 OLED Display

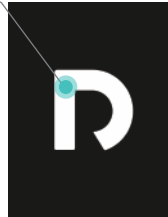

Booting

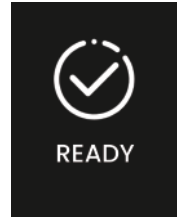

Available

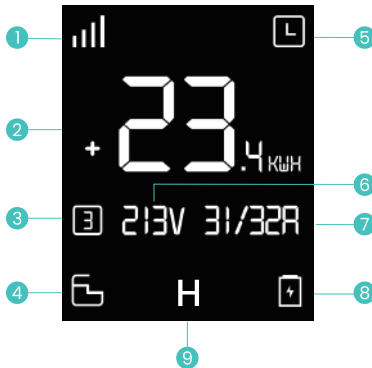

1 Connectivity

- Wi-Fi
- BLE
- 4G (optional)

2 Energy Delivered

3 Phase

- 1 Phase
- 3 Phase

4 EV Connected

- Cable plugged in, waiting for authorization
- Charging

5 Schedule

6 Voltage

7 Real-time Charging Current/ Current Available

8 Charging

- Charging
- Charging complete

Error Code

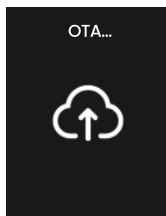

OTA

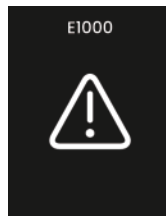

Faulted

9 Load Management

- H Home Balance activated
- Waiting for grid capacity restored
- H! CT error

- S Solar Only activated
- S! Waiting for surplus
- S! CT error
- E EMS connected

7.1 Plug And Charge (Default)



7.2 Authorization (Set In APP)

Pairing with APP

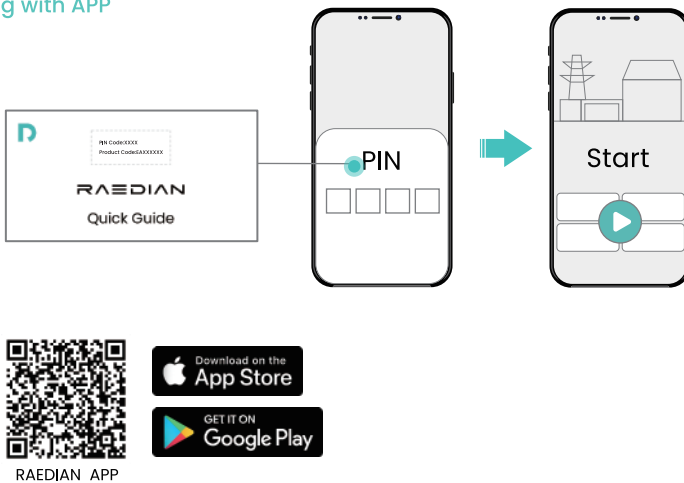

Authorized with RFID

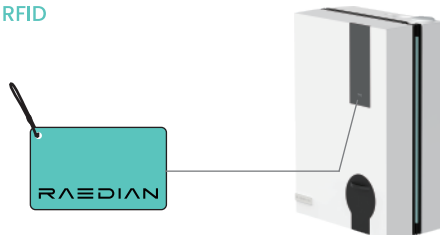

**CT clamp**

For dynamic load balancing

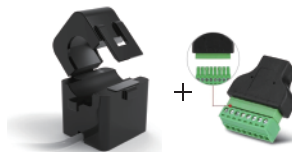
**CT kit**

For dynamic load balancing and solar charging

**Charging cable 7kW/22kW**

5m/7.5m, Type 2 to Type 2
Comes with a carry bag

**Pedestal with roof**

For charging station mounting

**Wall bracket**

Safe and secure installation on uneven surfaces

**Cable hook**

Convenient for keeping your charging cable organized



For more information,
please scan the QR code or visit us:
<https://raedian.com/support>



For instruction videos,
please scan the QR code or visit us:
<https://www.youtube.com/@EVWallboxRaedian>